

WEATHERHEAD PART NUMBER	AEROQUIP PART NUMBER	TH'D "T"	A REF	B REF	C REF	D REF	E REF	F ± 0.25 [± 0.10]	G REF	H REF
10004B-504	190672-4B	7/16-20	42.2 [1.66]	23.1 [.91]	14 [.55]	6.4 [.25]	4.3 [.17]	17.5 [.689]	1/2	4.3 [.17]
10006B-506	190672-6B	9/16-18	45.2 [1.78]	23.4 [.92]	14.2 [.56]	6.4 [.25]	7.6 [.30]	22 [.866]	5/8	4.3 [.17]

REVISIONS			
REV	DESCRIPTION	DATE	APPROVED
D	REDRAWN & RDESIGNED. UPDATED TO DANFOSS FORMAT & DIMENSION STYLE. 1) ADDED WEATHERHEAD PART NUMBERS.	2014-07-08 VSP	0099540-ECO

①

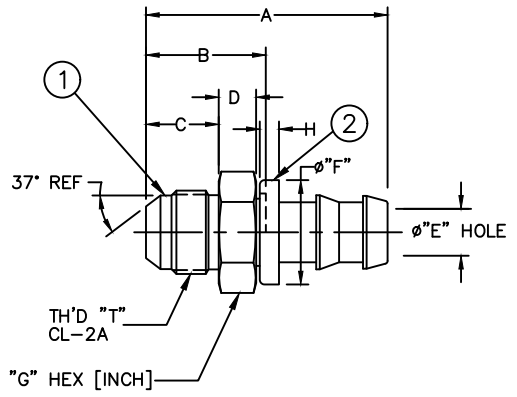

METRIC

①

10006B-506	190672-6B	FW1930-0606B	FF91126-6		
10004B-504	190672-4B	FW1930-0404B	FF91126-4		
WEATHERHEAD PART NUMBER	AEROQUIP PART NUMBER	① NIPPLE	② HOSE CAP		

LIST OF MATERIALS

ITEM NO.	MATERIAL	DRAWN V. PATIL	CHECKED V. PATIL	APPROVED Y. KULKARNI	RELEASE DATE 2014-07-08	0099540-ECO	THIRD ANGLE PROJECTION	SCALE	DIST	U	CAGE CODE	01276	SHEET	1
1	BRASS													
2	SANTOPRENE-BLUE													

Danfoss FLUID CONVEYANCE DIVISION

DRAWING TITLE
FITTING ASSEMBLY
SAE 37° MALE FLARE
SOCKETLESS TYPE, 2556 HOSE

SIZE A2 DRAWING NUMBER 190672-B REV D

SCALE NONE DIST U CAGE CODE 01276 SHEET 1

THE REPRODUCTION, DISTRIBUTION AND UTILIZATION OF THIS DOCUMENT AS WELL AS THE COMMUNICATION OF ITS CONTENTS TO OTHERS WITHOUT EXPLICIT AUTHORIZATION IS PROHIBITED. OFFENDERS WILL BE HELD LIABLE FOR THE PAYMENT OF DAMAGES. ALL RIGHT RESERVED IN THE EVENT OF THE GRANT OF A PATENT, UTILITY MODEL OR DESIGN. (PER ISO 16016)

1. DIMENSIONS ARE IN MILLIMETERS [INCHES].