

REV	DESCRIPTION	BY	CHK	DATE	ECN
A	ENGINEERING RELEASE	AGJ		2-27-04	M61155
B	(6A) MOUNTING TYPE WAS "A"	JSB		4-17-07	0004973

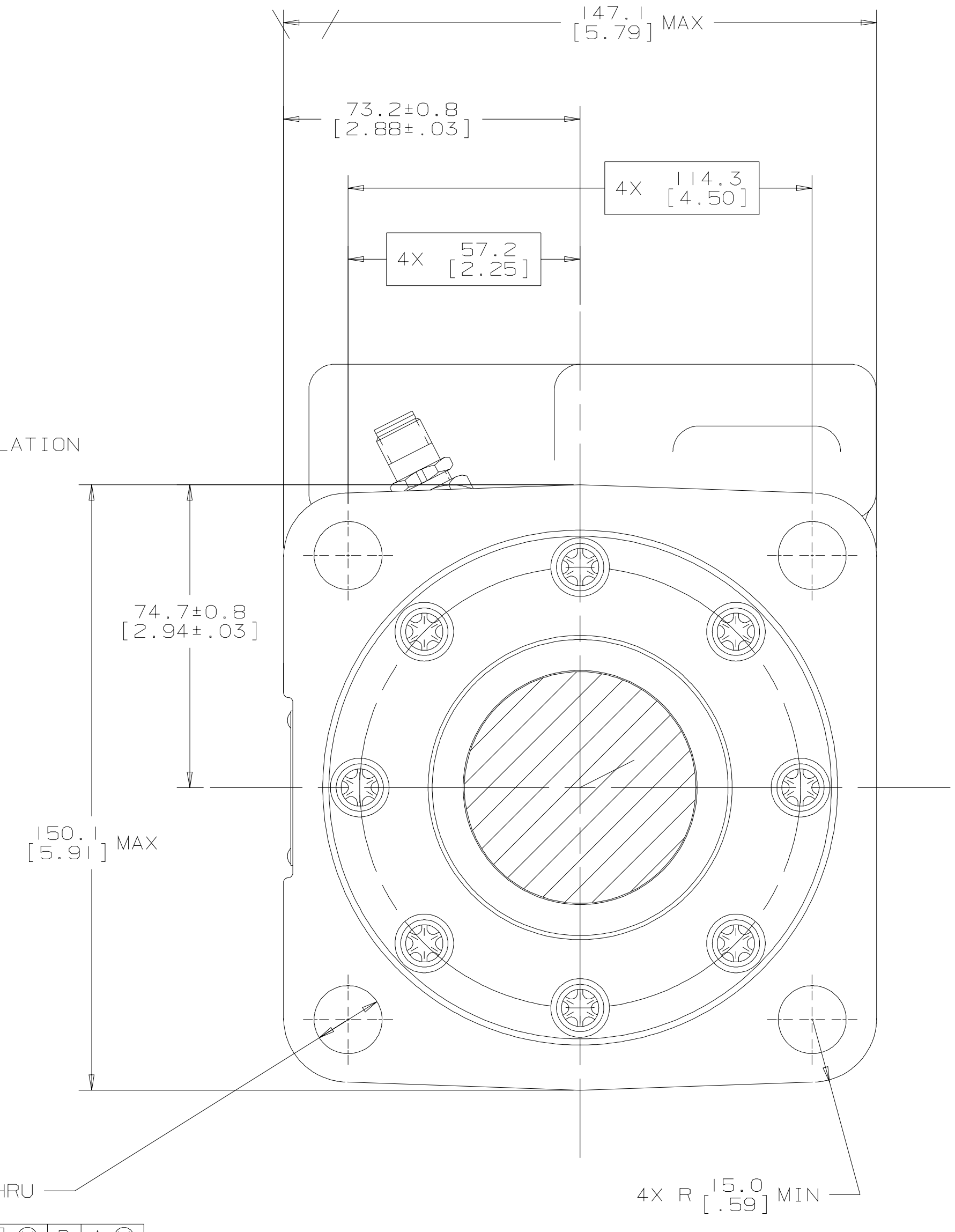
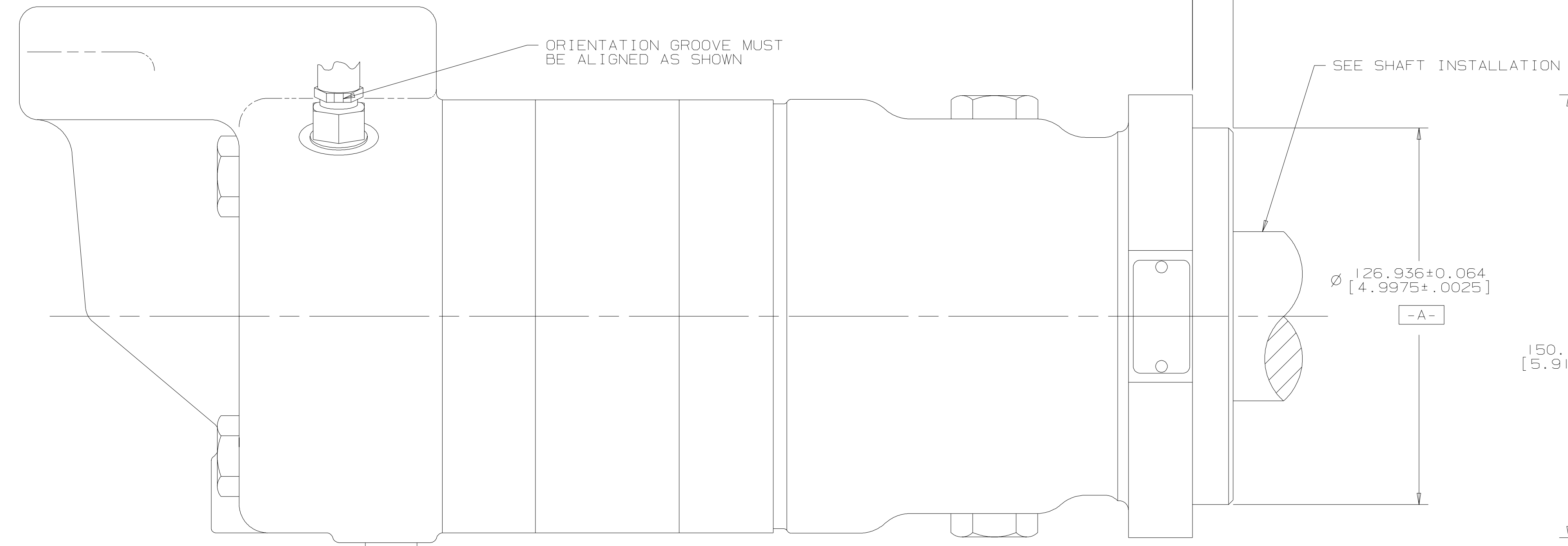
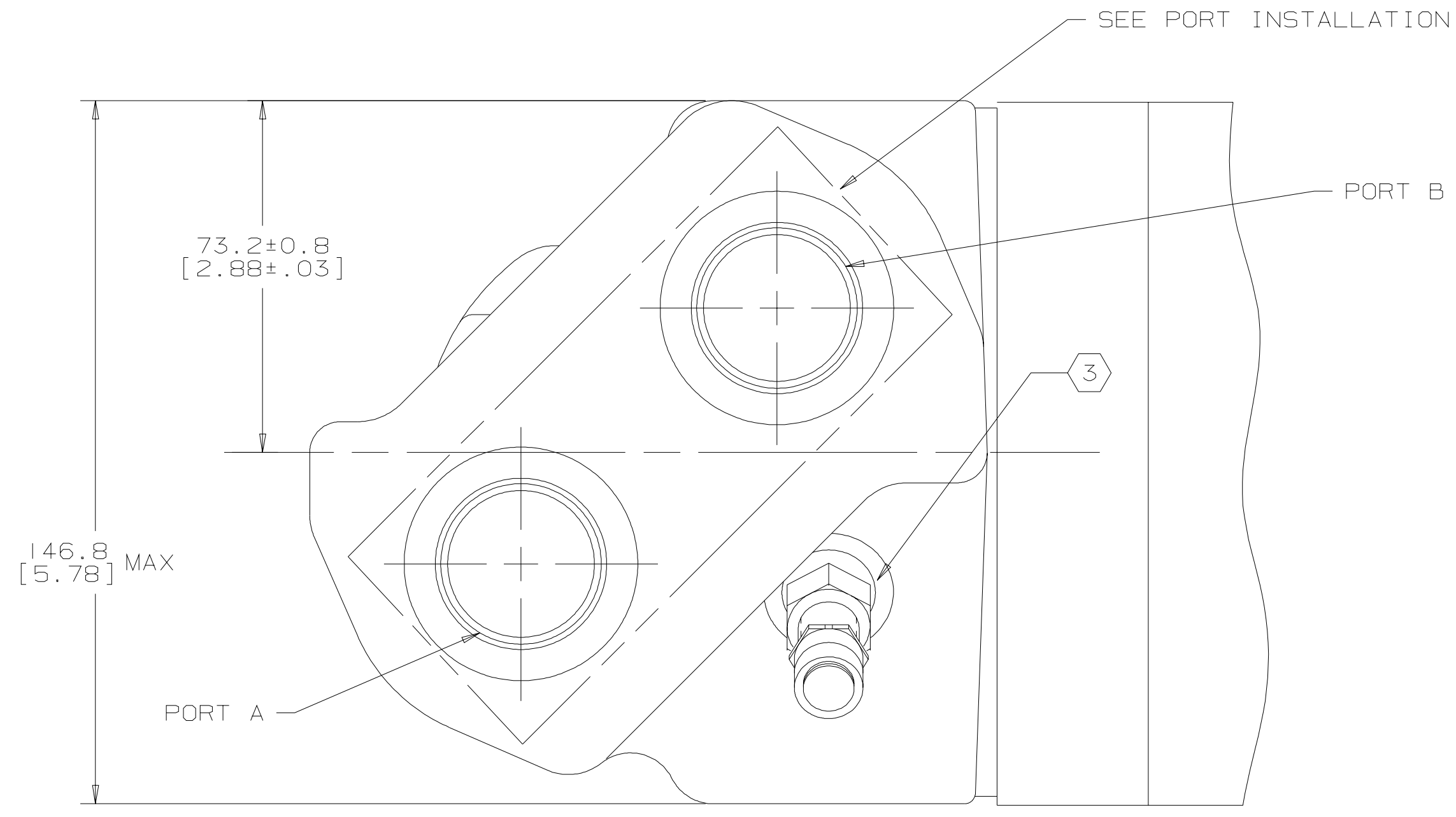

NOTE

1 ROTATION:  
 STANDARD: WHEN FACING SHAFT END OF MOTOR, SHAFT TO ROTATE:  
 CLOCKWISE WHEN PORT "A" IS PRESSURIZED  
 COUNTERCLOCKWISE WHEN PORT "B" IS PRESSURIZED  
 REVERSE: WHEN FACING SHAFT END OF MOTOR, SHAFT TO ROTATE:  
 CLOCKWISE WHEN PORT "B" IS PRESSURIZED  
 COUNTERCLOCKWISE WHEN PORT "A" IS PRESSURIZED

2 MOUNTING TYPE: AA  
 STANDARD: 4 BOLT: Ø127.0 [5.00] PILOT, Ø16.76 [.660] HOLES  
 ON Ø161.93 [6.375] BOLT CIRCLE.

3 NOMINAL SENSOR OUTPUT WILL BE 30 ELECTRICAL PULSES PER SHAFT  
 REVOLUTION  
 SUPPLY VOLTAGE: 8 TO 28 Vdc  
 OUTPUT VOLTAGE: LOW .5 Vdc AT 10 mA; HIGH Vs-1 Vdc

4X Ø 16.76±0.25 THRU  
 [Ø 0.30 [.012] B A M]

UNLESS OTHERWISE SPECIFIED ALL DIMENSIONS ARE IN: INCHES <input type="checkbox"/> MILLIMETERS <input checked="" type="checkbox"/>		DRAWING BASED ON ANSI Y14.5M-1982	
THE REPRODUCTION, DISTRIBUTION, AND UTILIZATION OF THIS DOCUMENT, AS WELL AS THE COMMUNICATION OF ITS CONTENTS TO OTHERS WITHOUT EXPLICIT AUTHORIZATION IS PROHIBITED. OFFENDERS WILL BE HELD LIABLE FOR THE PAYMENT OF DAMAGES. ALL RIGHTS RESERVED IN THE EVENT OF THE GRANT OF A PATENT, UTILITY MODEL, OR DESIGN. (PER ISO 16016)			
TOLERANCES		MATERIAL/HEAT TREAT	
.X + - - - -	DRAIN BY/DATE AGJ 3-19-04		
.XX + - - - -	CHECKED BY/DATE SMM 5-12-04		
.XXX + - - - -	ENGR. BY/DATE DAT 5-12-04	TITLE	
< - - - - -	METALLURGY BY/DATE	10,000 SERIES MOTOR INSTALL	
UNSPECIFIED RADI ARE	THIRD ANGLE PROJECTION	MICROINCHES (MICROINCHES)	NUMBER
UNSPECIFIED DRAFT ANGLES ARE	DO NOT SCALE	ARTHEMETICAL AVERAGE	A-828-005
DRAWING FORMAT CAD <input checked="" type="checkbox"/> MANUAL <input type="checkbox"/>		SCALE 1/1	SHEET 1 OF 1