

REV	DESCRIPTION	BY	DATE	ECN
A	ENGINEERING RELEASE	AGJ	4-7-93	M8051
B	REVISED	AGJ	5-28-93	22833
C	-1) MOVED DATUM B -2) 56.6/54.4 [2.23/2.14] WAS 50.3/48.0 [1.98/1.89]	JMM	9-7-94	25945
D	NOTE 1 WAS MOUNTING TYPE: OPTION C	AGJ	5-13-02	41044
E	56.4/54.4 [2.22/2.14] WAS 56.6/54.4 [2.23/2.14]	AGJ	5-17-04	47918
F	NOTE 2 WAS OUTPUT SHAFT: OPTION 02 & 24	PM	4-4-06	54522
G	-1) UPDATED TO ASME Y14.5-2009 STANDARD -2) MAX COUPLING LENGTH WAS 47.3 [1.86]	NRI	05-12-14	M92814

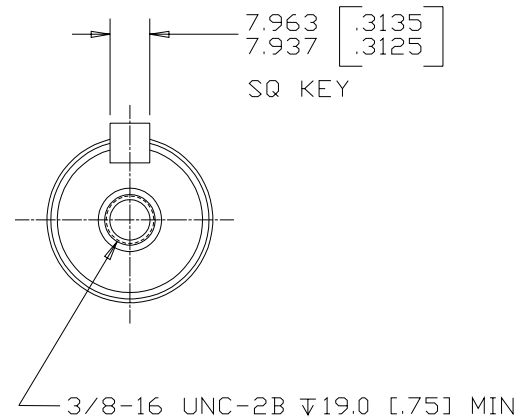
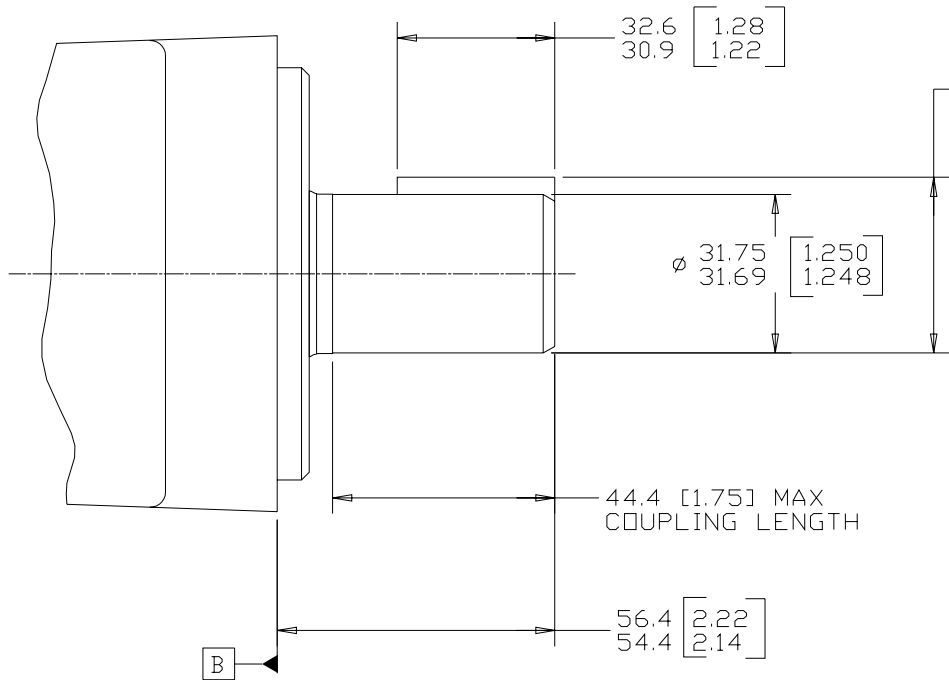

REVIEWED FOR CLASSIFICATION PER ESP -042

NOTE

- 1 MOUNTING TYPE: OPTION AC, BA & BE
- 2 OUTPUT SHAFT: OPTION 02 & 17

UNLESS OTHERWISE SPECIFIED ALL DIMENSIONS ARE IN INCHES <input type="checkbox"/> MILLIMETERS <input checked="" type="checkbox"/>		DRAWING BASED ON ASME Y14.5-2009	
TOLERANCES x ± ---- xx ± REF xxx ± ONLY ∠ ± ----		THE REPRODUCTION, DISTRIBUTION, AND UTILIZATION OF THIS DOCUMENT, AS WELL AS THE COMMUNICATION OF ITS CONTENTS TO OTHERS WITHOUT EXPLICIT AUTHORIZATION IS PROHIBITED. OFFENDERS WILL BE HELD LIABLE FOR THE PAYMENT OF DAMAGES. ALL RIGHTS RESERVED IN THE EVENT OF THE GRANT OF A PATENT, UTILITY MODEL, OR DESIGN. (PER ISO 16016)	
UNSPECIFIED RADII ARE ----		DRAWN BY/DATE: A. JOHNSON 3-16-93 CHECKED BY/DATE: S. RICHARDS 4-8-93 ENGRG BY/DATE: M. BERNSTROM 4-8-93 METALLURGY BY/DATE: -----	MATERIAL/HEAT TREAT TITLE: 2000 SERIES MOTOR SHAFT INSTALLATION
UNSPECIFIED DRAFT ANGLES ARE ----		<input type="checkbox"/> MICROINCHES <input type="checkbox"/> MICROMETERS (MICROINCHES)	NUMBER: A-683-002
B SIZE		<input checked="" type="checkbox"/> ARITHMETICAL AVERAGE THIRD ANGLE PROJECTION DO NOT SCALE	SCALE: 1/1 SHEET 1 OF 1

